

# RoVent<sup>®</sup> Jr.

Automatic Ventilator  
Volume & Pressure Controlled

## User's Guide

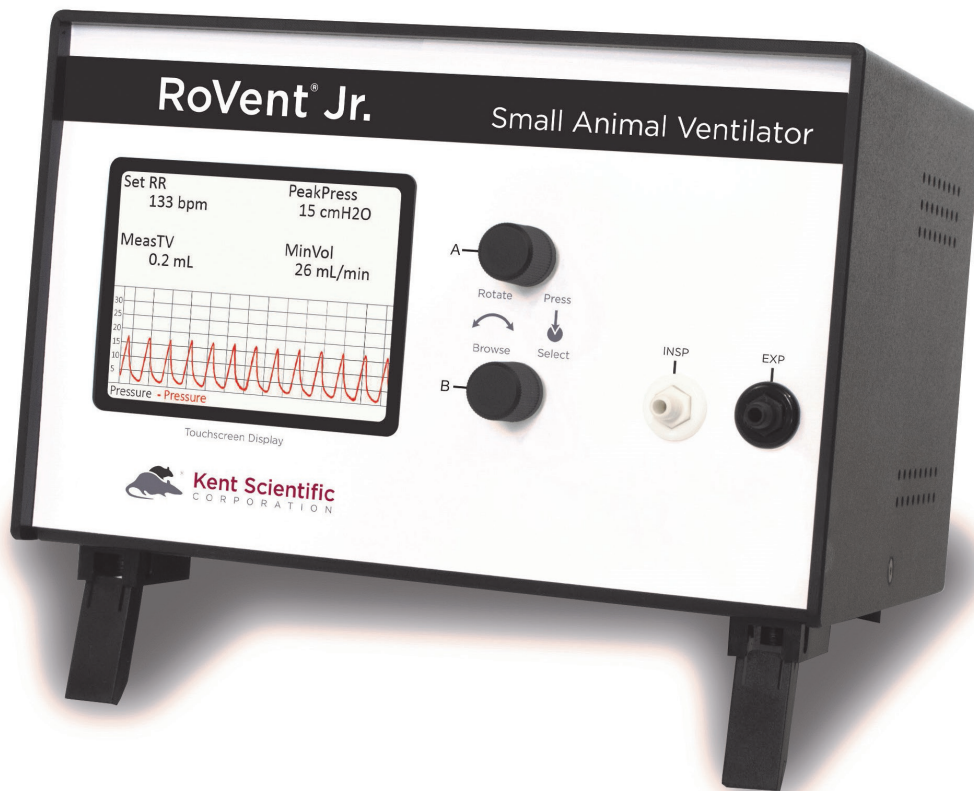

# RoVent<sup>®</sup> Jr.

Automatic Ventilator  
Volume & Pressure Controlled

## User's Guide

# TABLE OF CONTENTS

<b>Introduction .....</b>	<b>1</b>
System Components .....	1
Navigating RoVent® Jr. ....	2
Touchscreen .....	2
Control .....	2
Display Options .....	3
Menus .....	4
Alarms .....	4
<b>RoVent® Jr.</b>	
<b>Automatic Ventilator.....</b>	<b>5</b>
Set Up Hardware .....	5
Ventilating an Animal.....	7
Configure Settings.....	8
Troubleshooting .....	9
<b>General Information.....</b>	<b>11</b>
Contact .....	11
Warranty and Satisfaction Guarantee .....	11
Specifications .....	12
<b>Index.....</b>	<b>14</b>

# Introduction

The RoVent® Jr. is not designed, intended or authorized for use in human applications.

## System Components

### Front Panel

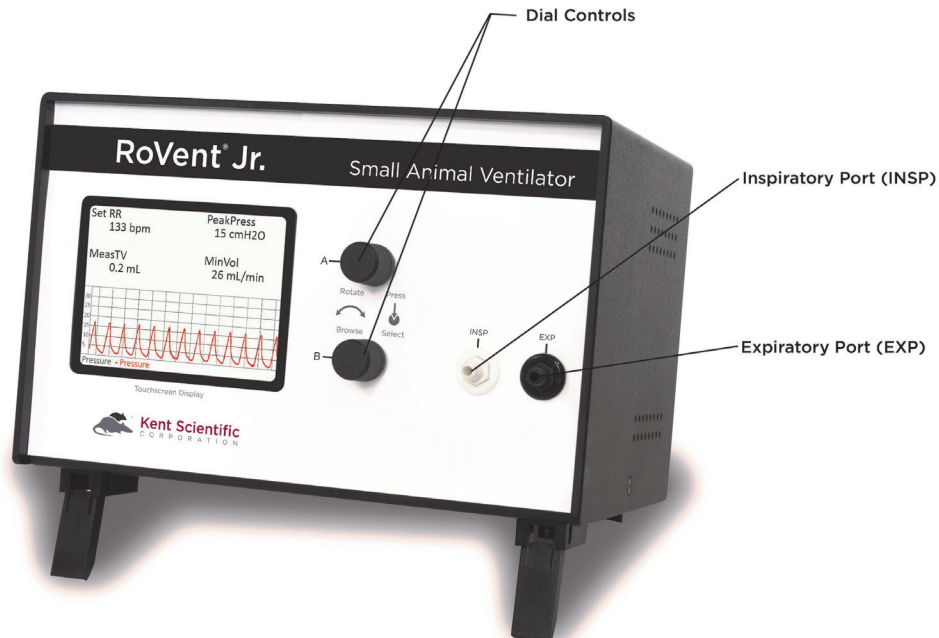

### Back Panel



### Side Panel

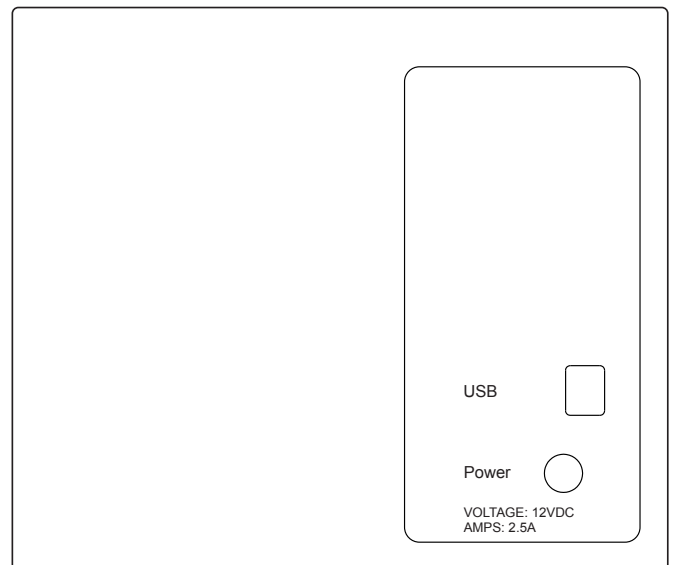

---

## Navigating RoVent® Jr.

### Touch Screen

RoVent® Jr. Touch Screens offer quick access to most features and settings. Touch the upper half of the Run Screen to reach the first Touch Screen.

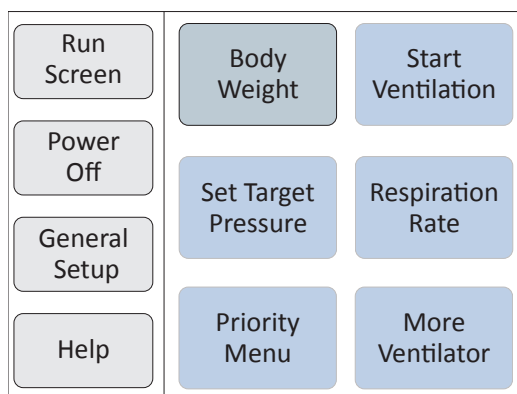

First Touch Screen

(Screen buttons may vary based on the modules installed.)

Touch the bottom half of the Run Screen to open the pop-up Display Menu and quickly scroll through charts, view other data or to silence Alarms.

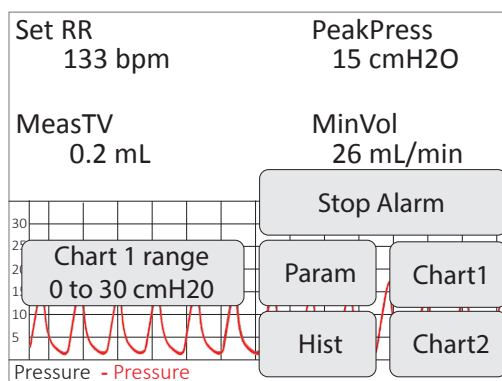

Pop-Up Display Menu

(Screen buttons may vary based on the modules installed.)

### Dial Control

There are two Dials, A and B. The function of a Dial varies based on:

- where you use it – from the Touch Buttons Screens, Run Screen, Menu Screens or Main Menu.
- how you use it – turn, press or hold down.

---

Dials can have specialized uses in a few specific locations. The unit displays on-screen instructions in those locations.

ACTION	DIAL	RESULT
Press	A	Back one level from Main Menu Screens To Run Screen from Main Menu To Run Screen from Touch Button Screens
	B	Select a highlighted Menu item To Main Menu from Home Screen Clear Alarms if they are enabled
Turn	A	Move through Menu choices
	B	Change setting values at Menus
Hold down	A	To Main Menu from Run Screen To Help at any Menu screen
	B	—

**See Main Menu  
on page 4.**

## ***Display Options***

### **Customizing the Run Screen Display:**

#### **To configure Parameters:**

1. Touch:
  - 1) the upper half of the Run Screen for the Touch Screen Menu.
  - 2) “General setup”.
  - 3) “Config”.
  - 4) “Param Locations”.
2. Turn Dial A to choose a Parameter and Dial B to assign the Parameter to a Run Screen location.

#### **To configure Charts:**

1. Touch:
  - 1) the upper half of the Run Screen for the Touch Screen Menu.
  - 2) “General setup”.
  - 3) “Config”.
  - 4) “Chart 1 setup” or “Chart 2 setup” to choose the type and timing for a chart.
2. Press Dial A to return to the General setup page of the Touch Screen Menu.
3. Touch “Set ranges” to choose the best-fitting axis range for the Parameters on your charts.

## Menus

The Main Menu is the non-touch gateway to all features and setting choices for configuring RoVent® Jr., useful when a touch screen is not a feasible option, such as for an operator with damp hands. Access the Main Menu through the Touch Screen Menu or from the Run Screen by holding Dial A.

Main Menu	
Body wgt	Set body weight
Vent	
Modules	30g
Config	Nominal RR: 133bpm
Power off	Nominal Tidal Vol: 0.200mL
Help	Nominal Minute Vol: 26mL/min
	Turn Dial B to choose the weight of your animal
	Hold Dial A for Help.

### Main Menu

(Screen buttons may vary based on the modules installed.)

## Alarms

RoVent® Jr. system alarms alert you to certain conditions that might require attention while RoVent® Jr. is running.

There are two levels of alarms:

Level	Based On	Banner	Sound (If On)	Configurable
Warning	Parameters or other operating conditions	Yellow	1-beep pattern	Yes
Serious	Parameters or other operating conditions	Red	3-beep pattern	Yes except for system alarms

### *To clear a sounding alarm:*

A triggered alarm produces a colored banner at the bottom of the screen describing the cause of the alarm. The banner color corresponds to the severity of the alarm.

To silence the alarm:

Touch:

- 1) the bottom half of the Run Screen.
- 2) "Stop Alarm".



# RoVent® Jr. Automatic Ventilator



## Set Up Hardware

### *Air Source:*

#### **If you are using a Compressed Gas Source or an Anesthetic Vaporizer:**

1. Connect the Vaporizer Connection Assembly with Bypass to the back of the RoVent® Jr.
2. Connect the compressed gas or vaporizer to the inlet side of the bypass assembly.

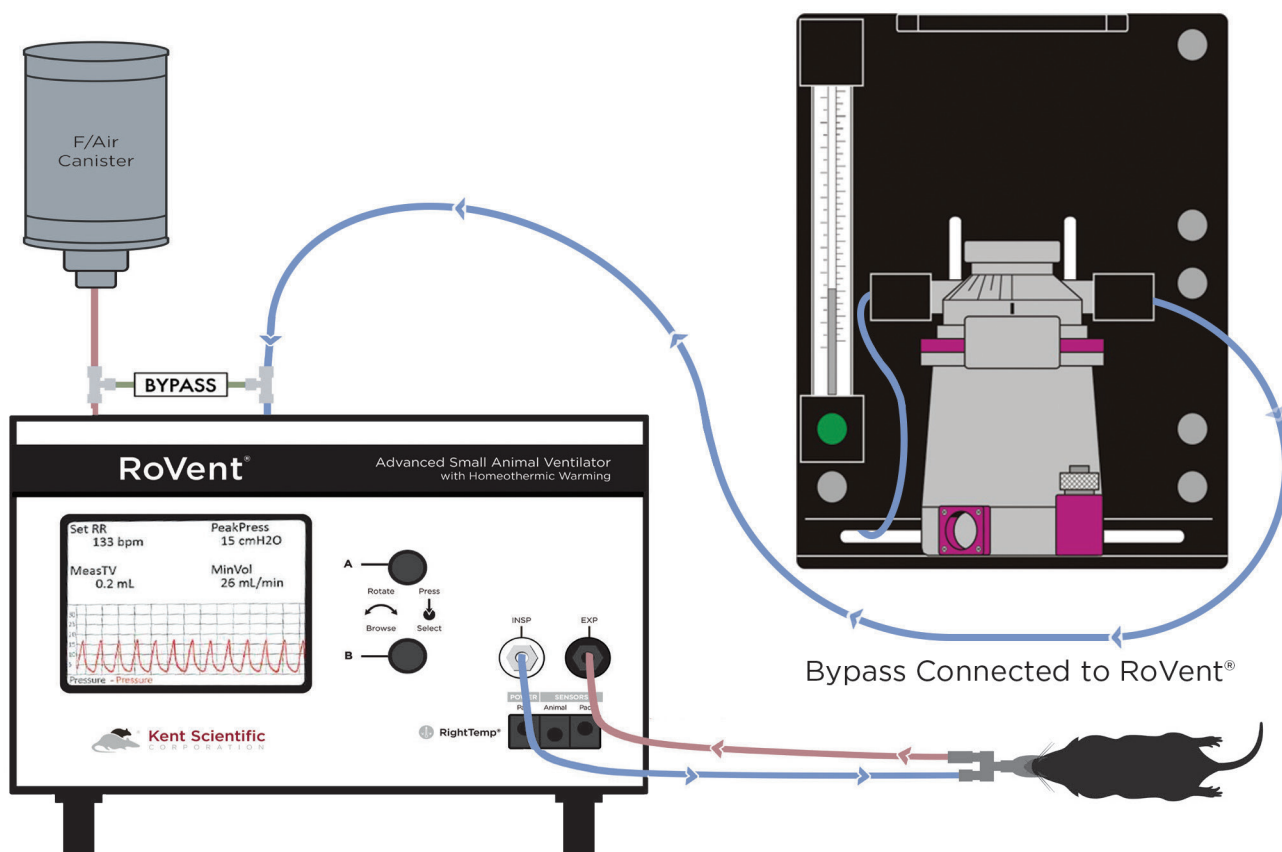

#### **If you are using air:**

No additional hardware setup is necessary.





## Scavenging:

### If you are using a Compressed Gas Source or an Anesthetic Vaporizer:

Connect a charcoal canister to the exhaust side of the bypass assembly.

## Tubing Configurations:

### Connecting Ventilator Tubing to an Endotracheal Tube:

Connect the intubation connector tubing directly to the INSP and EXP ports on the front of the RoVent® Jr.

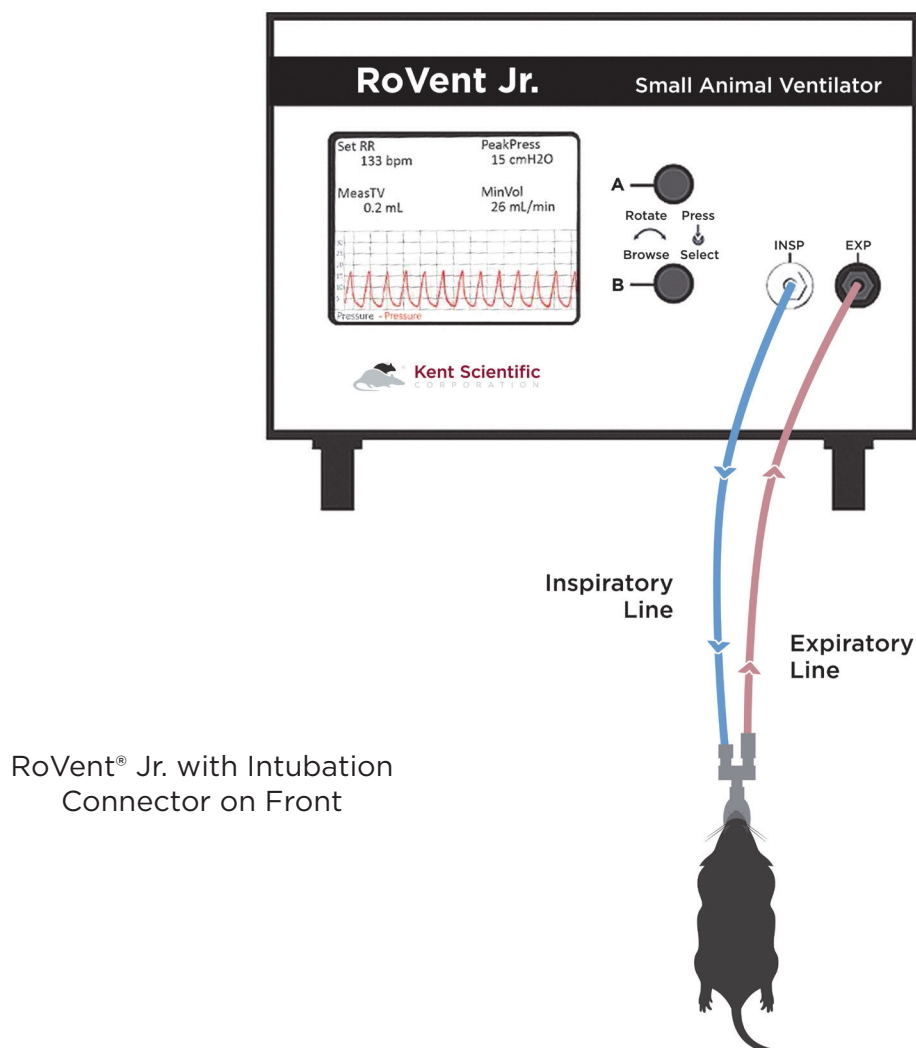



## Ventilating an Animal

---

1. Anesthetize and intubate the animal. Connect the endotracheal tube to the intubation connector.
2. Touch “Start ventilator” to begin ventilation.

**RoVent® Jr. calculates the respiration rate and tidal volume using the animal’s body weight. To change these settings, touch “More ventilator”, then “Respiration rate” or “Set target pressure/volume”. This will override the calculated settings.**

3. At the end of the procedure touch “Stop ventilator” to stop ventilation. Allow the animal to recover.



# Configure Settings

## Ventilator Calibrations

**Note:** Never perform these functions when an animal is connected to the ventilator.

### 1. Measure Deadspace

- 1) Set up tubing.
- 2) Touch “Calib & tests”, then “Measure deadspace”.
- 3) Firmly seal the end of the endotracheal tube with your finger or a cap, ensuring that there is no air leakage.
- 4) Press Dial B. When asked to confirm measurement, press Dial B again.

### 2. Zero Sensors

- 1) Set up tubing.
- 2) Touch “Calib & tests”, then “Zero sensors”.
- 3) Press Dial B. When asked to confirm measurement, press Dial B again.

### 3. Make Ventilator Settings

Configure all anesthesia settings and air supply settings first (see page 7).

1. Touch:
  - 1) “Select Ventilator” for access to all RoVent® touch menus.
  - 2) “Body Weight” to choose the body weight that determines the automatic settings for respiration rate and tidal volume. To change these Parameters manually, Touch “Respiration rate” or “Set target volume”.
2. Choose a ventilator priority by touching “More ventilator”, then “Priority Menu”.

**Pressure Priority:** RoVent® ventilates to a specified inspiratory pressure. The default target pressure is 15cmH<sub>2</sub>O independent of body weight setting. To change the target pressure, touch “Set target pressure”.

**Volume Priority:** RoVent® delivers an initial target pressure for the first breath, then delivers a target tidal volume. The default target tidal volume is calculated based on body weight. To change the target tidal volume, touch “Set target volume”.

**Note:** You can change the initial target pressure for the first breath, as well as the minimum and maximum allowed pressures to customize the ventilator’s operating range as the ventilator delivers the set tidal volume.



# RoVent® Troubleshooting

## Alarm Messages

Problem	Possible Cause
<b>Tube open to atmosphere</b> The highest measured pressure in a breath cycle is under 25% of the target and the tidal volume is over target.	<ul style="list-style-type: none"><li>• Part of the tubing between the INS and EXP ports is open, disconnected or leaking.</li><li>• There is a large mismatch between the set or calculated tidal volume and the required tidal volume, or between the set and actual body weights.</li></ul>
<b>Tube blocked</b> The highest measured pressure in a breath cycle is under 25% of the target and tidal volume is under target.	<ul style="list-style-type: none"><li>• The endotracheal tube is not seated correctly.</li><li>• There is a kink, blockage or foreign matter in the inspiratory or expiratory lines.</li></ul>
<b>Exhaust blocked</b> The breath pressure fails to drop during the expiratory phase of a breath.	<ul style="list-style-type: none"><li>• The cap is on the EXP port.</li><li>• The expiratory valve has failed.</li></ul>
<b>Out of regulation</b> Over five consecutive breaths, peak pressure was more than 25% or less than 75% of your target.	<ul style="list-style-type: none"><li>• Requested Tidal Volume is too high for Pressure and RR .</li></ul>
<b>Large rise in TV</b> Over the last four breaths, there was an increase of more than 25% in average tidal volume compared to that of the previous 16 breaths.	<ul style="list-style-type: none"><li>• Part of the tubing between the INS and EXP ports is open, disconnected or leaking.</li></ul>
<b>Large drop in TV</b> Over the last four breaths, there was a decrease of more than 25% in average tidal volume compared to that of the previous 16 breaths.	<ul style="list-style-type: none"><li>• There is a kink in the tubing.</li><li>• There is foreign matter in the tubing or in the exhaust valve.</li><li>• The exhaust outlet is blocked.</li><li>• The endotracheal tube is not seated correctly.</li></ul>
<b>Deadspace calib</b> Dead space calibration produced a negative tidal volume.	<ul style="list-style-type: none"><li>• Deadspace calibration is incorrect for current tubing setup.</li></ul>



## Diagnostic Procedures

To access these diagnostic procedures, touch “Calib & tests”.

### Purge

Resulting Message	Meaning	Possible Action
<b>Success</b>	No leaks found.	None is needed.
<b>Low baffle pressure</b>	There is an internal RoVent problem.	Contact Kent Scientific.
Clears any accumulations from the valves using high pressure air flow.		

### Leak Test

Checks for internal leaks as well as leaks in tubing circuits.

Resulting Message	Meaning	Possible Action
<b>Test OK</b>	No leaks found.	None is needed.
<b>Tubing leaks</b>	The tubing is open to the atmosphere through a loose connection or a crack or hole in the tubing.	Tighten all connections and ensure that the circuit is air tight. Run Leak test again. If the error recurs, contact Kent Scientific.
<b>Low baffle pressure or Baffle leaks</b>	There is an internal RoVent problem.	Retest making sure that the tubing is not flexed or moved. If the error recurs, contact Kent Scientific.

# General Information

Thank you for purchasing a RoVent® Jr. We truly appreciate your business. We strongly advise that you read and study this Owner's Manual to appreciate fully all the features, benefits, and capabilities of the RoVent® Jr.

## Contact Information

---

Kent Scientific Corporation  
1116 Litchfield Street  
Torrington, Connecticut 06790  
E-mail: [sales@kentscientific.com](mailto:sales@kentscientific.com)

Toll-Free: 888-5RATTUS (888-572-8887)  
Outside US: 860-626-1172  
Fax: 860-626-1179  
Internet: [www.kentscientific.com](http://www.kentscientific.com)

## Disclaimer

---

Kent Scientific Corporation makes no representations or warranties, expressed, statutory or implied, regarding the fitness or merchantability of the components of this system for any particular purpose. Further, Kent Scientific Corporation is not liable for any damages, including but not limited to, lost profits, lost savings, or other incidental or consequential damages arising from ownership or use of these products, or for any delay in the performance of its obligations under the warranty due to causes beyond its control. In no case shall Kent Scientific Corporation's financial obligation extend beyond the cost of or replacement of the Kent product in question. Kent Scientific Corporation also reserves the right to make any improvements or modifications to these products described in this manual at any time, without notice of these changes. All brand and product names used in this manual are the trademarks of their respective owners.

**This product is not designed, intended or authorized for use in human applications.**

## Product Warranty

---

The RoVent® Jr has a one (1) year warranty including all parts and labor charges. This warranty does not cover damage by any cause including, but not limited to, any malfunction, defect or failure caused by or resulting from unauthorized service or parts, improper maintenance, operation contrary to furnished instructions, shipping or transit accidents, modifications or repair by the user, harsh environments, misuse, neglect, abuse, accident, incorrect line voltage, fire, flood, other natural disasters, or normal wear and tear. Changes or modifications not approved by Kent Scientific Corporation could void the warranty. The foregoing is in lieu of all other expressed warranties. Kent Scientific Corporation does not assume or authorize any party to assume for it any other obligation or liability.

---

## Satisfaction Guarantee

Should you experience difficulty with the RoVent® Jr, our Technical Support Group will assist you in trouble-shooting and determining if the product needs to be returned to our facility. We will issue you a Return Manufacturer Authorization (RMA) number before the product is shipped back for repair. It is at the discretion of the manufacturer to replace or repair a defective part or product. Please call Customer Service at 888-572-8887 to obtain a Return Manufacturer Authorization number. Shipments without a RMA number will not be accepted. Please note that after our 30-day return policy period ends, we will be happy to assist you with your application, but cannot issue any credit or refund for a returned RoVent Jr.

Prior to shipment, please clean and decontaminate the product of any chemical, biological, or isotopic contamination. Please include a completed Product Return Form with the shipment. The form can be found on page 68 of this Owner's Manual. This form can be obtained by contacting Kent Scientific Customer Service at 888-572-8887 or 860-626-1172.

## Specifications

### *Controller*

Voltage	12 V, 2.5A
Dimensions	13.3cm (5.25in) x 19.1cm (7.50in) x 13.9cm (5.50in)
Weight	1.0kg

### *Power Supply*

Input	100 to 240 V, 50 to 60 Hz, 1.0 A
Output	12 V, 2.5 A

---

## RoVent

Control Modes	Volume controlled, pressure controlled
Respiratory Rate Range	20bpm to 400bpm
Tidal Volume Range	0.01 - 12.0mL
Weight Range	3g to 1,250g

RoVent Jr. is a registered trademark of Kent Scientific Corporation.



# Index

air flow .....	10	leak test .....	10	touch screen menu .....	3, 4
alarms .....	2-4	low baffle pressure .....	10	triggered alarm .....	4
anesthesia .....	8	main menu .....	2-4	tubing configurations .....	6
Anesthetic .....	5, 6	maintenance .....	11	TV .....	9
axis .....	3	more ventilator .....	2, 7, 8	vaporizer .....	5, 6
baffle leaks .....	10	param .....	2, 3	ventilator .....	2, 6-8
body weight .....	2, 4, 7, 8	parameters .....	3, 4, 8	view .....	2
body wgt .....	4	param locations .....	3	volume priority .....	8
breath cycle .....	9	port .....	9	warranty .....	11
bypass .....	5, 6	pressure .....	2, 7-10, 13		
calib & tests .....	8, 10	pressure priority .....	8		
canister .....	6	priority menu .....	2, 8		
charcoal .....	6	range .....	2, 3, 8, 13		
compressed gas .....	5, 6	respiration rate .....	2, 7, 8		
config .....	3, 4	run screen .....	2-4		
data .....	2	set ranges .....	3		
dials .....	2	set target pressure .....	2, 7, 8		
display menu .....	2	set target volume .....	8		
endotracheal tube .....	6-9	specifications .....	12		
exhaust .....	1, 6, 9	stop alarm .....	2, 4		
expiratory lines .....	9	target pressure .....	2, 7, 8		
exp port .....	9	tidal volume .....	7-9, 13		
inlet .....	1, 5	tidal volume .....	9		
intubation connector tubing ..	6	timing .....	3		



**Kent Scientific**  
C O R P O R A T I O N

1116 Litchfield Street  
Torrington, Connecticut 06790  
Local: 860-626-1172 Toll-Free: 888-572-8887  
Part No. 10-6000-28